

KOBELCO

SK330-10/SK350LC-10

SK330 SK350_{LC}



We Save You Fuel
Achieving a Low-Carbon Society

Power Meets Efficiency



SK330 SK350_{LC}

16%
Higher fuel saving
means
"Efficiency"

Increase in
productivity
means
"Power"

Compared to H-mode on the SK330-8

To urban centers and mines around the world.

Kobelco's all-out innovation brings you durable earth-friendly construction machinery suitable for any task and sites all over the planet. With greater fuel economy we deliver higher efficiency to any project.

Kobelco SK330 SK350LC machines are also more durable than ever, able to withstand the rigors of the toughest job sites.

It all adds up to new levels of value that are a step ahead of the times. While focusing on the global environment of the future, Kobelco offers next-generation productivity to meet the need for lower life cycle costs and exceed the expectations of customers globally.



Evolution Continues, with Improved Fuel Efficiency.

In Pursuit of Improved Fuel Efficiency

Operation Mode

Fuel consumption is lower in H-mode/S-mode/ECO-mode in comparison with the previous model (Generation 8).

■ Compared to previous models



H H-mode	16%
S S-mode	19%
E ECO-mode	24%

Values are approximate improvement rate.

Always and Forever.

**Yesterday, Today, and Tomorrow.
Obsessed with Fuel Efficiency.**

Over the past 10 years, Kobelco has achieved an average reduction of about 37% in fuel consumption. And we vow to continue to lead in fuel efficiency.

■ Compared to SK330-6 model (2006)

E ECO-mode (SK330-10)	
.....	37%

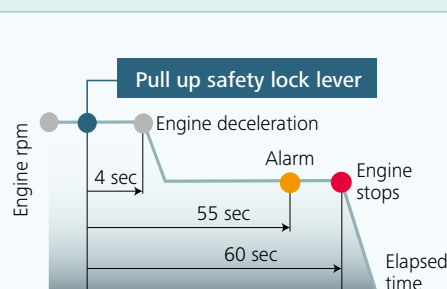

AIS (Auto Idle Stop)

If the safety lock lever is lifted up, the engine will stop automatically. This eliminates wasteful idling during standby, saving fuel and reducing CO₂ emissions as well.

16%
Higher fuel saving
means
"Efficiency"

The new arm interflow system more efficiently controls hydraulic fluid flow, and significant reduction of in-line resistance and pressure loss boosts fuel efficiency by about 16%*.

The electronic-control common-rail engine features high-pressure fuel injection and multiple injection with improved precision.

* Compared to H-mode on the SK330-8



Hydraulic System: Revolutionary Technology Saves Fuel

Arm Interflow System NEW

When lowering the boom, this system uses the downward force generated by the boom's weight to push fluid to the shovel arm cylinder. This greatly reduces the need to apply power from outside the system.

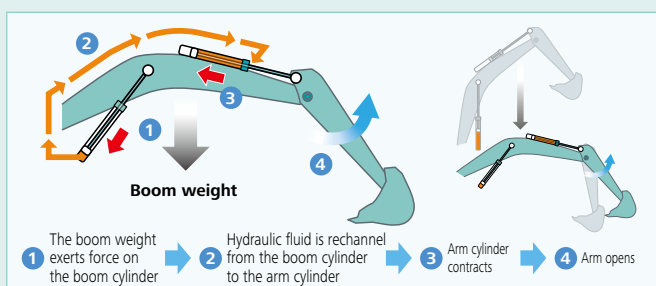

Pursuing maximum fuel efficiency

Common Rail System

High-pressure injection atomizes the fuel, and more precise injection improves combustion efficiency. This also contributes to better fuel economy.

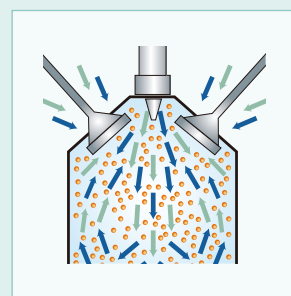

Hydraulic Circuit Reduces Energy Loss

We have made every effort to enhance fuel efficiency by minimizing hydraulic pressure resistance, improving the hydraulic line layout to control friction resistance loss and minimizing valve resistance.

Improved hydraulic piping is an effective means of reducing pressure loss.

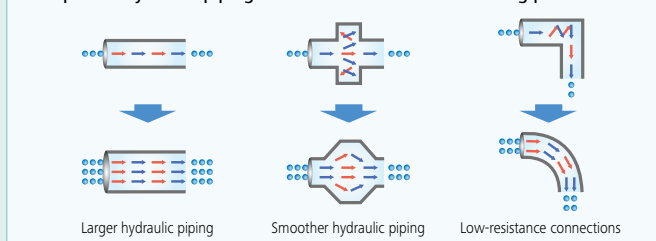

More Power and Higher Efficiency.

The highly efficient hydraulic system minimizes fuel consumption while maximizing power. With nimble movement and superior digging power, this excavator promises to improve your job productivity.

Improved Fuel Efficiency Contributes to High Performance

Superior Digging Performance

Powerful digging force delivers outstanding performance.

■ Max. Bucket Digging Force

Normal: **222kN**

With power boost: **244kN**

■ Max. Arm Crowding Force

Normal: **163kN**

With power boost: **180kN**

*Values are for STD arm (3.3m)



Get More Done Faster with Superior Operability

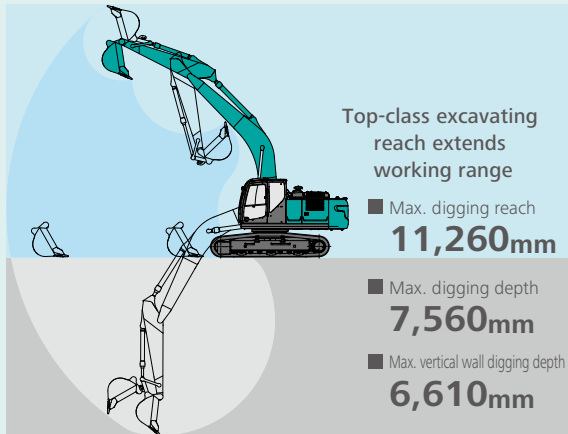

*Values are for STD arm (3.3m)

A Light Touch on the Lever Means Smoother, Less Tiring Work NEW

It takes 38% less effort to work the operation lever, which reduces fatigue over long working hours or continued operations.



Top Class Traveling Force

Powerful traveling force and drawbar pulling force deliver plenty of speed when climbing slopes or negotiating bad roads, and the agility to change direction swiftly and smoothly.

■ Drawbar Pulling Force: **333kN**



Operator-friendly Features Include Controls that Are Easy to See, Easy to Use



Multi-Display in Color

Brilliant colors and graphic displays are easy to recognize on the LCD multi-display in the console. The display shows fuel consumption, maintenance intervals, and more.

- 1 Analog gauge provides an intuitive reading of fuel level and engine water temperature
- 2 Green indicator light shows low fuel consumption during operation
- 3 Fuel consumption/Switch indicator for rear camera images
- 4 Digging mode switch
- 5 Monitor display switch

One-Touch Attachment Mode Switch

A simple touch of a button, switches the hydraulic circuit and flow amount to match attachment changes. Icons help the operator to confirm the proper configuration at a glance.



Fuel consumption



Maintenance

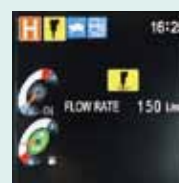

Breaker mode

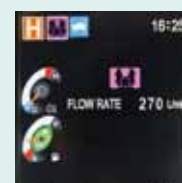

Nibbler mode



Rearview monitoring (Option)

Increased Power, with Enhanced Durability to Maintain the Machine's Value

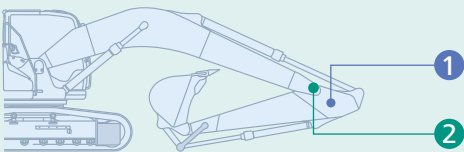

Built to Operate in Tough Working Environments

The attachment has been reinforced to handle a higher work volume, with greater power and excellent durability that can withstand demanding work conditions.

1 Enlarged Reinforcement of the Arm Foot

HD: Base plate thickness has been increased.



2 Modified Foot Boss Shape

The arm foot boss shape has been modified and improved to distribute stress, delivering more strength for tasks like digging next to a wall.

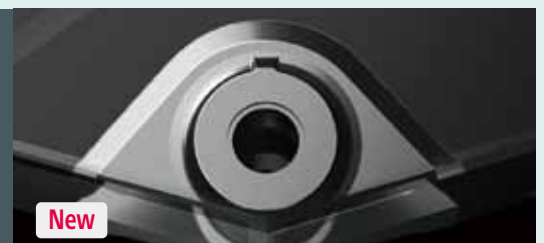

Increase in
productivity
means
"Power"

Structural design increases strength,
while eliminating hydraulic problems.
Enhanced durability takes
productivity to a new level.



Improved Filtration System Reliability

Clean, contaminant-free fuel and hydraulic fluid are essential to stable performance. The improved filtration systems reduce the risk of mechanical trouble and enhance longevity and durability.

Hydraulic Fluid Filter NEW

Recognized as the best in the industry, our Premium-fine filter separates out even the smallest particles. New cover prevents contamination when changing filters.



Hydraulic Fluid Filter Clog Detector NEW

Hydraulic tank pressure sensor monitors the pressure difference between the return line and tank inside pressure to determine the degree of clogging. If the difference exceeds a predetermined level, a warning appears on the multi-display, so any contamination can be trapped by the filter and replaced before it reaches the hydraulic fluid in the tank.

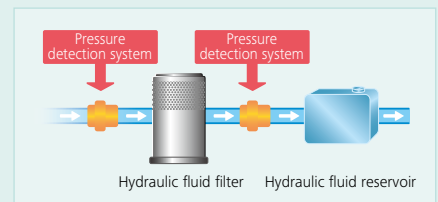

Metal Mesh Cover NEW Air Cleaner

Metal mesh cover ensures strength and durability.



Fuel Filter

The pre-filter with built-in water separator has 1.8 times more filter area compared to the previous models and with a new final stage maintenance free fuel filter to maximize filtering performance.

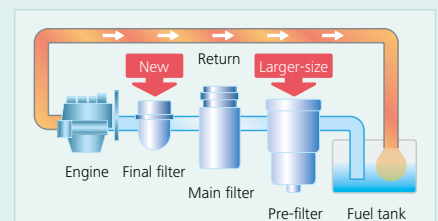

Comfortable Cab Is Now Safer than Ever.

A work environment that is quieter and more comfortable. A cab that puts the operator first is key to improved safety.

Comfort

Super-Airtight Cab



The high level of air-tightness keeps dust out of the cab.

Quiet Inside

The high level of air-tightness ensures a quiet, comfortable cabin interior.

Low Vibration

Coil springs absorb small vibrations, and high suspension mounts filled with silicone oil reduce heavy vibration. The long stroke achieved by this system provides excellent protection from vibration.

Twice the stroke of a conventional mount

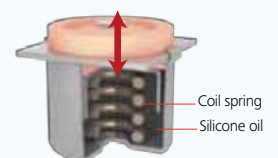

Broad View Liberates the Operator

The front window features one large piece of glass without a center pillar on the right side for a wide, unobstructed view.

Air Conditioner Louvers behind the Seat

NEW

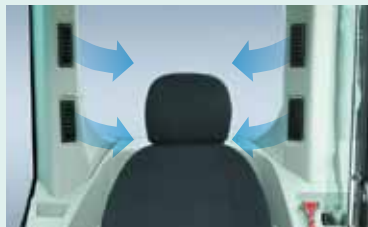

The large air-conditioner has louvers on the back pillars that blow from behind and to the right and left of the operator's seat. They can be adjusted to put a direct flow of cool/warm air on the operator, which means a more comfortable operating environment.

More Comfortable Seat Means Higher Productivity



Seat recliner can be pushed back flat



Double slides allow adjustment for optimum comfort



Large Cab Is Easy to Get in and Out of

The expanded cab provides plenty of room for a large door, more headroom and smoother entry and exit.

Interior Equipment Adds to Comfort and Convenience

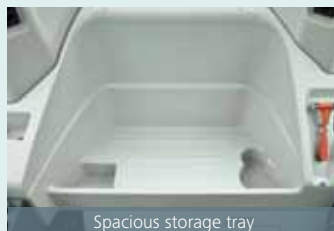

Spacious storage tray



Large cup holder

Safety

ROPS Cab

ROPS (Roll-Over-Protective Structure)-compliant cab clears ISO standards (ISO-12117-2: 2008) and ensures greater safety for the operator should the machine tip over.



Expanded Field of View for Greater Safety

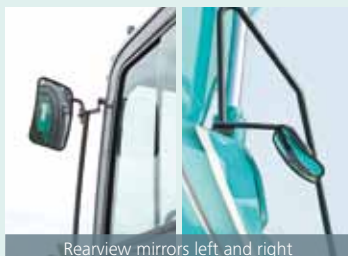

Rearview mirrors left and right

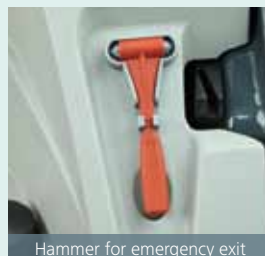

Hammer for emergency exit

Greater safety assured by rearview mirrors on left and right.

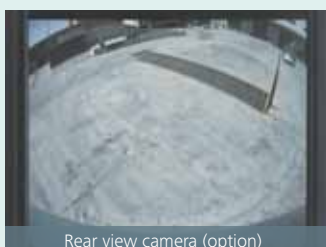

Rear view camera (option)



A rear view camera is installed as option to simplify checking for safety behind the machine. The picture appears on the color monitor.





Remote Monitoring for Peace of Mind

KOMEXS uses satellite communication and internet to relay data, and therefore can be deployed in areas where other forms of communication are difficult.

When a hydraulic excavator is fitted with this system, data on the machine's operation, such as operating hours, location, fuel consumption, and maintenance status can be obtained remotely.

Direct Access to Operational Status

Location Data

- Accurate location data can be obtained even from sites where communications are difficult.



Latest location

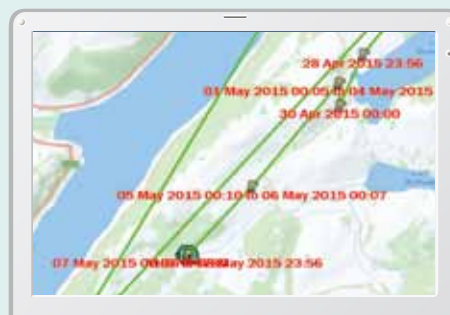

Location records

Period: 11 Apr, 2015 to 10 May, 2015 Search			
Type of Operation	Working Hrs	Ratio	
Total Working Hrs	169 Hrs	100 %	
Digging Hrs	72.2 Hrs	43 %	
Traveling Hrs	18.3 Hrs	11 %	
Idle Hrs	15.9 Hrs	9 %	
Opt Att Hrs	62.5 Hrs	37 %	
Crane Mode Hrs	0 Hrs	0 %	

Work data

Operating Hours

- A comparison of operating times of machines at multiple locations shows which locations are busier and more profitable.
- Operating hours on site can be accurately recorded, for running time calculations needed for rental machines, etc.

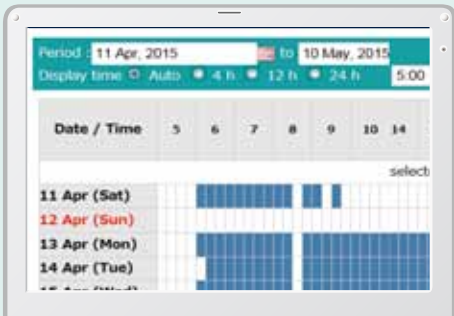

Daily report

Fuel Consumption Data

- Data on fuel consumption and idling times can be used to indicate improvements in fuel consumption.

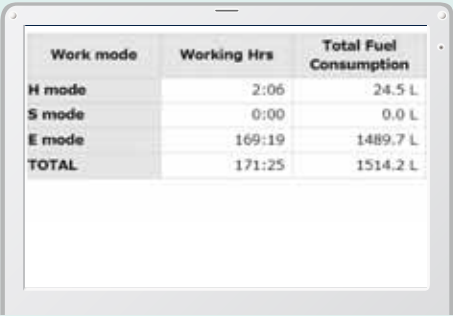

Fuel consumption

Graph of Work Content

- The graph shows how working hours are divided among different operating categories, including digging, idling, traveling and optional operations.

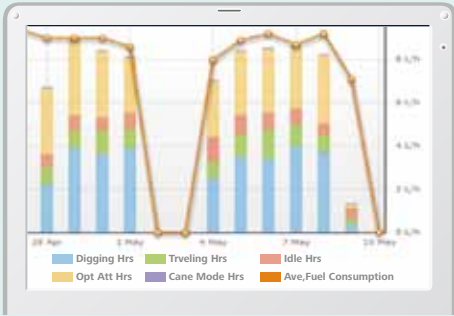

Work status

Maintenance Data and Warning Alerts

Machine Maintenance Data

- Provides maintenance status of separate machines operating at multiple sites.
- Maintenance data is also relayed to KOBELCO service personnel, for more efficient planning of periodic servicing.



Maintenance

Warning Alerts

- This system warns an alert if an anomaly is sensed, preventing damage that could result in machine downtime.

Alarm Information Can Be Received through E-mail

- Alarm information or maintenance notice can be received through E-mail, using a computer or cell phone.



Messages displayed when the machine returns to the set area.

Daily/Monthly Reports

- Operational data downloaded onto a computer helps in formulating daily and monthly reports.

Security System

Engine Start Alarm

- The system can be set an alarm if the machine is operated outside designated time.

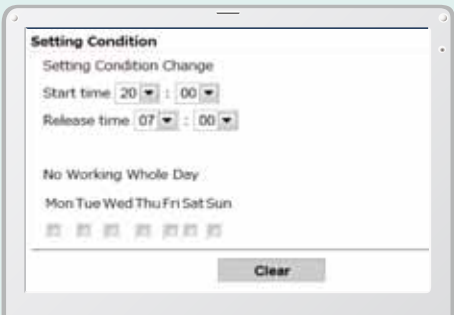

Engine start alarm outside prescribed work time

Area Alarm

- It can be set an alarm if the machine is moved out of its designated area to another location.

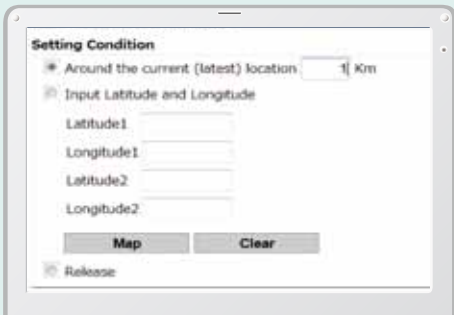

Alarm for outside of reset area



Easy, On-the-Spot Maintenance NEW

There is ample space in the engine compartment for a mechanic to do maintenance work inside. The distance between steps is lower so entry and exit is easier. And the mechanic can work in comfort, without contortions or unnatural body positions. Finally, the hood is lighter and easier to raise and lower.



Generous space for maintenance work



Step/Hand rail



Double-element air cleaner

Maintenance Work, Daily Checks, Etc., Can Be Done from Ground Level

The layout allows for easy access from the ground for many daily checks and regular maintenance tasks.



Fuel filter with built-in water-separator



Fuel filter



Right side

- ① Fuel filter
- ② Fuel filter with built-in water-separator
- ③ Engine oil filter



Left side

Simple layout for easy access to radiator and cooling system elements.

Efficient Maintenance Keeps the Machine in Peak Operating Condition.



Machine Information Display Function

- Displays only the maintenance information that's needed, when it's needed
- Self-diagnostic function provides early-warning detection and display of electrical system malfunctions
- Service-diagnostic function makes it easier to check the status of the machine
- Record function of previous breakdowns including irregular and transient malfunction



Examples of displaying maintenance information

	INTERVAL	REMAINING TIME	EXCHANGE DAY
ENGINE OIL	500	495	--/--/--
FUEL FILTER	500	495	--/--/--
HYD. FILTER	1000	995	--/--/--
HYD. OIL	2000	1995	--/--/--

More Efficient Maintenance Inside the Cab



Internal and external air conditioner filters can be easily removed without tools for cleaning.

Easy Cleaning

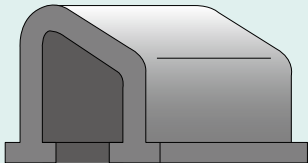
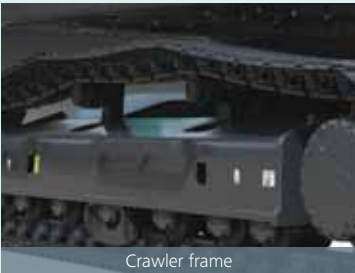

Special crawler frame design for easy mud removal cleaning.



Detachable two-piece floor mat with handles for easy removal. A floor drain is located under floor mat.

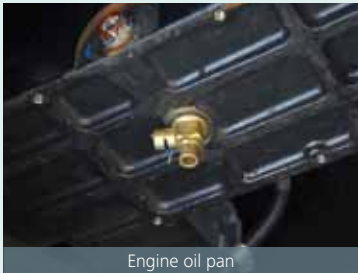

Engine oil pan equipped with drain valve.

Long-life hydraulic oil: **2,000** hours

Long-Interval Maintenance
Long-life hydraulic oil reduces cost and labor.

Replacement cycle: **1,000** hours

Highly Durable Premium-fine Filter
The high-capacity hydraulic oil filter incorporates glass fiber with superior cleaning power and durability.





Engine

Model	HINO J08EUN
Type	Four-stroke liquid-cooled direct injection diesel turbo charged with intercooler
No. of cylinders	6
Bore and stroke	112 mm X 130 mm
Displacement	7.684 L
Rated power output	188 kW/2,100 min ⁻¹ (ISO 9249) 200 kW/2,100 min ⁻¹ (ISO 14396)
Max. torque	969 N•m/1,600 min ⁻¹ (ISO 9249) 998 N•m/1,600 min ⁻¹ (ISO 14396)



Hydraulic System

Pump	
Type	Two variable displacement piston pumps + one gear pump
Max. discharge flow	2 x 294 L/min, 1 x 21 L/min
Relief valve setting	
Boom, arm and bucket	34.3 MPa {350 kgf/cm ² }
Power Boost	37.8 MPa {385 kgf/cm ² }
Travel circuit	34.3 MPa {350 kgf/cm ² }
Swing circuit	29.0 MPa {296 kgf/cm ² }
Control circuit	5.0 MPa {50 kgf/cm ² }
Pilot control pump	Gear type
Main control valves	8-spool
Oil cooler	Air cooled type



Swing System

Swing motor	Axial-piston motor
Brake	Hydraulic; locking automatically when the swing control lever is in neutral position
Parking brake	Wet multiple plate
Swing speed	10 min ⁻¹ {rpm}
Tail swing radius	3,600 mm
Min. front swing radius	4,310 mm



Attachments

Backhoe bucket and arm combination

Use		Backhoe bucket	
		Normal digging	
Bucket capacity	ISO heaped m ³	2.1	1.6
	ISO Struck m ³	1.5	1.2
Opening width	With side cutters mm	1,614	1,600
	Without side cutters mm	1,460	1,470
No. of bucket teeth		5	5
Bucket weight kg		1,900	1,290
Combinations	2.25 m super short arm	◎	○
	3.30 m standard arm	◎	○



Travel System

Travel motors		Variable displacement piston pump
Travel brakes		Hydraulic
Parking brakes		Wet multiple plate
Travel shoes	SK330	45 each side
	SK350LC	48 each side
Travel speed		5.6/3.3 km/h
Drawbar pulling force		333 kN (ISO 7464)
Gradeability		70 % {35°}



Cab & Control

Cab
All-weather, sound-suppressed steel cab mounted on the high suspension mounts filled with silicone oil and equipped with a heavy, insulated floor mat.
Control
Two hand levers and two foot pedals for travel
Two hand levers for excavating and swing
Electric rotary-type engine throttle



Boom, Arm & Bucket

Boom cylinders	140 mm x 1,550 mm
Arm cylinder	170 mm x 1,788 mm
Bucket cylinder	150 mm x 1,193 mm



Refilling Capacities & Lubrications

Fuel tank	503 L
Cooling system	35 L
Engine oil	28.5 L
Travel reduction gear	2 x 8.0 L
Swing reduction gear	7 L
Hydraulic oil tank	245 L tank oil level
	410 L hydraulic system



Working Ranges

Unit: m

Boom		6.50m	
Arm		Super short 2.25 m	Standard 3.3 m
Range			
a- Max. digging reach		10.36	11.26
b- Max. digging reach at ground level		10.15	11.06
c- Max. digging depth		6.51	7.56
d- Max. digging height		10.29	10.58
e- Max. dumping clearance		7.06	7.37
f- Min. dumping clearance		3.73	2.62
g- Max. vertical wall digging depth		4.33	6.61
h- Min. swing radius		4.49	4.31
i- Horizontal digging stroke at ground level		3.39	5.82
j- Digging depth for 2.4 m (8') flat bottom		6.31	7.4
Bucket capacity ISO heaped m ³		2.1	1.6

Digging Force (ISO 6015)

Unit: kN

Arm length	Super short 2.25 m	Standard 3.3 m
Bucket digging force	220 242*	222 244*
Arm crowding force	232 255*	163 180*

*Power Boost engaged.

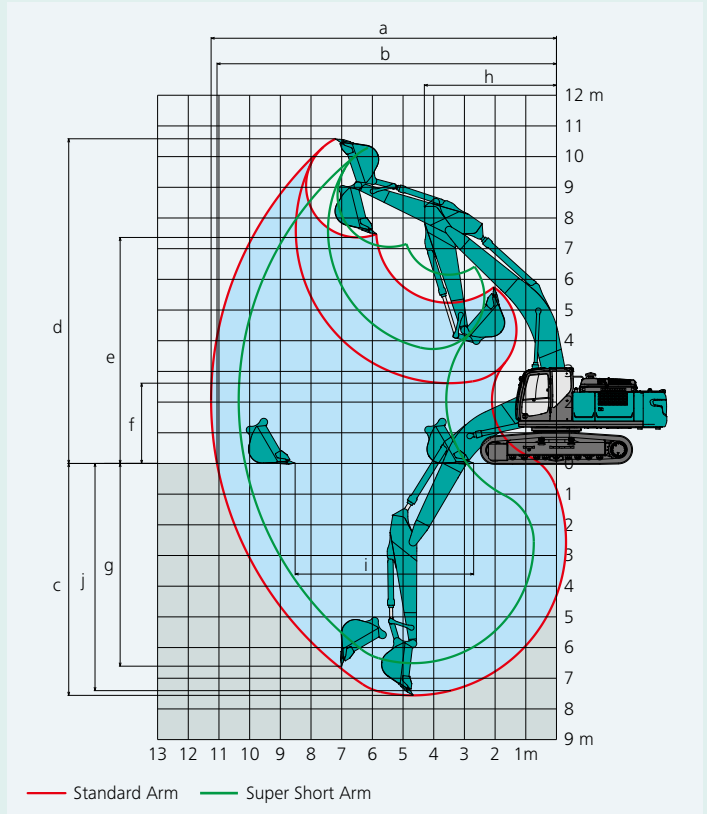

Dimensions

Arm length		Super short 2.25 m	Standard 3.3 m
A Overall length		11,510	11,300
B Overall height (to top of boom)		3,760	3,430
C Overall width		3,190	
D Overall height (to top of cab)		3,150	
E Ground clearance of rear end*		1,200	
F Ground clearance*		500	
G Tail swing radius		3,600	

Unit: mm		
G'	Distance from center of swing to rear end	3,600
H	Tumbler distance	SK330 3,720
		SK350LC 4,050
I	Overall length of crawler	SK330 4,650
		SK350LC 4,960
J	Track gauge	2,590
K	Shoe width	600
L	Overall width of upperstructure	2,980

*Without including height of shoe

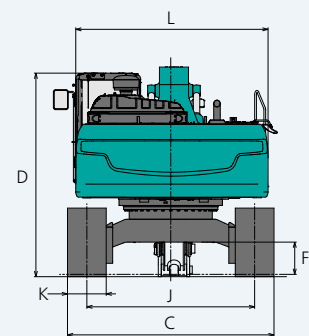
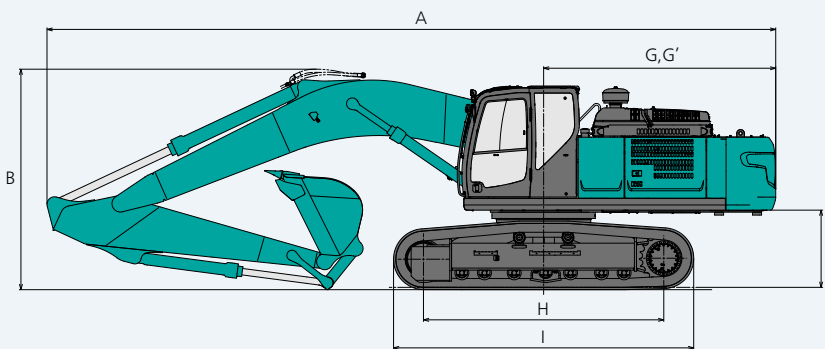

Operating Weight & Ground Pressure

In standard trim, with standard boom, super short arm 2.25 m, and 2.1 m³ ISO heaped bucket

Shaped			Triple grouser shoes (even height)	
Shoe width	mm		600	800
Overall width	mm		3,190	3,390
Ground pressure	kPa	SK330	71.5	55.4
		SK350LC	68	52
Operating weight	kg	SK330	35,400	36,600
		SK350LC	36,100	37,300

Lifting Capacities

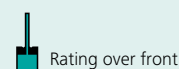
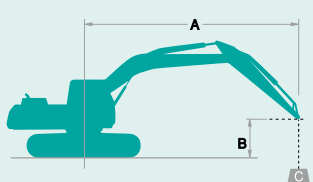

Rating over front











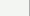



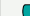
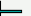

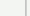

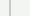
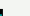

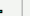

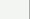

Rating over side or 360 degrees

A: Reach from swing centerline to arm top
B: Arm top height above/below ground
C: Lifting capacities in Kilograms
Bucket: Without bucket
Relief valve setting: 34.3 MPa (350 kgf/cm²)

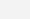
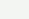
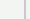
SK330 Super Short Arm: 2.25 m Bucket: Without Shoe: 800 mm Counterweight: 7,890 kg												
B \ A		3.0 m		4.5 m		6.0 m		7.5 m		At Max. Reach		Radius
7.5 m	kg					*8,450	*8,450			*8,400	*8,400	6.73 m
6.0 m	kg					*8,800	*8,800	*8,090	7,280	*8,080	6,920	7.71 m
4.5 m	kg					*9,720	*9,720	*8,350	7,070	*8,000	6,000	8.31 m
3.0 m	kg					*10,800	9,230	*8,830	6,780	7,800	5,540	8.61 m
1.5 m	kg					*11,590	8,770	*9,230	6,520	7,630	5,390	8.64 m
G.L.	kg					*11,810	8,540	9,150	6,380	7,870	5,540	8.40 m
-1.5 m	kg			*14,640	12,950	*11,370	8,520	*8,890	6,390	*8,260	6,050	7.87 m
-3.0 m	kg	*15,420	*15,420	*12,790	*12,790	*10,010	8,720			*8,110	7,220	6.98 m
-4.5 m	kg			*9,290	*9,290					*7,170	*7,170	5.56 m



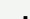
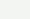





SK330 Short Arm: 2.60 m Bucket: Without Shoe: 800 mm Counterweight: 7,890 kg												
B \ A		3.0 m		4.5 m		6.0 m		7.5 m		At Max. Reach		Radius
7.5 m	kg									*7,790	*7,790	7.06 m
6.0 m	kg					*8,330	*8,330	*7,630	7,300	*7,570	6,520	8.00 m
4.5 m	kg			*11,970	*11,970	*9,290	*9,290	*7,990	7,060	*7,530	5,680	8.58 m
3.0 m	kg					*10,420	9,260	*8,530	6,750	7,410	5,250	8.87 m
1.5 m	kg					*11,320	8,750	*9,010	6,470	7,240	5,100	8.89 m
G.L.	kg			*15,750	12,710	*11,680	8,470	9,070	6,290	7,440	5,210	8.66 m
-1.5 m	kg			*14,930	12,760	*11,410	8,400	*8,960	6,250	*8,000	5,650	8.15 m
-3.0 m	kg	*16,830	*16,830	*13,300	13,000	*10,320	8,540			*8,000	6,650	7.29 m
-4.5 m	kg	*12,690	*12,690	*10,270	*10,270					*7,500	*7,500	5.95 m

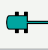

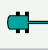



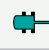

SK330		Standard Arm: 3.30 m Bucket: Without Shoe: 600 mm Counterweight: 7,890 kg															
A	B	1.5 m		3.0 m		4.5 m		6.0 m		7.5 m		9.0 m		At Max. Reach			
																Radius	
9.0 m	kg														*5,750	*5,750	6.56 m
7.5 m	kg										*6,910	*6,910			*5,260	*5,260	7.86 m
6.0 m	kg										*7,010	*7,010			*5,080	*5,080	8.71 m
4.5 m	kg								*8,610	*8,610	*7,490	7,050	*6,910	5,220	*5,080	4,970	9.25 m
3.0 m	kg						*13,360	*13,360	*9,860	9,290	*8,140	6,700	7,120	5,070	*5,250	4,620	9.52 m
1.5 m	kg						*15,280	12,950	*10,960	8,700	*8,750	6,380	6,950	4,900	*5,580	4,490	9.54 m
G.L.	kg						*15,930	12,470	*11,600	8,320	8,840	6,150	6,820	4,790	*6,150	4,560	9.33 m
-1.5 m	kg				*13,950	*13,950	*15,590	12,370	*11,640	8,160	8,720	6,040			6,950	4,870	8.85 m
-3.0 m	kg		*15,880	*15,880	*19,570	*19,570	*14,400	12,500	*10,970	8,200	*8,490	6,080			*7,560	5,560	8.07 m
-4.5 m	kg				*15,910	*15,910	*12,080	*12,080	*9,170	8,460					*7,450	7,080	6.88 m

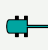

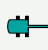

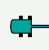

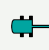

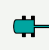

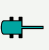

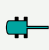
SK330		Standard Arm: 3.30 m Bucket: Without Shoe: 800 mm Counterweight: 7,890 kg														
A	B	1.5 m		3.0 m		4.5 m		6.0 m		7.5 m		9.0 m		At Max. Reach		
																Radius
9.0 m	kg													*5,750	*5,750	6.56 m
7.5 m	kg									*6,910	*6,910			*5,260	*5,260	7.86 m
6.0 m	kg									*7,010	*7,010			*5,080	*5,080	8.71 m
4.5 m	kg							*8,610	*8,610	*7,490	7,240	*6,910	5,380	*5,080	*5,080	9.25 m
3.0 m	kg					*13,360	*13,360	*9,860	9,550	*8,140	6,900	*7,170	5,230	*5,250	4,770	9.52 m
1.5 m	kg					*15,280	13,340	*10,960	8,960	*8,750	6,580	7,180	5,060	*5,580	4,640	9.54 m
G.L.	kg					*15,930	12,860	*11,600	8,590	9,130	6,340	7,050	4,950	*6,150	4,710	9.33 m
-1.5 m	kg			*13,950	*13,950	*15,590	12,760	*11,640	8,430	9,010	6,230			*7,100	5,030	8.85 m
-3.0 m	kg	*15,880	*15,880	*19,570	*19,570	*14,400	12,890	*10,970	8,460	*8,490	6,280			*7,560	5,740	8.07 m
-4.5 m	kg			*15,910	*15,910	*12,080	*12,080	*9,170	8,720					*7,450	7,300	6.88 m

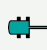

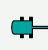

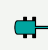



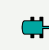

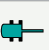

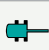
Notes:

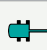
- Do not attempt to lift or hold any load that is greater than these lifting capacities at their specified lift point radius and heights. Weight of all accessories must be deducted from the above lifting capacities.
- Lifting capacities are based on machine standing on level, firm, and uniform ground. User must make allowance for job conditions such as soft or uneven ground, out of level conditions, side loads, sudden stopping of loads, hazardous conditions, experience of personnel, etc.
- Arm top pin is defined as lift point.
- The above lifting capacities are in compliance with ISO 10567. They do not exceed 87% of hydraulic lifting capacity or 75% of tipping load. Lifting capacities marked with an asterisk (*) are limited by hydraulic capacity rather than tipping load.
- Operator should be fully acquainted with the Operator's and Maintenance Instructions before operating this machine. Rules for safe operation of equipment should be adhered to at all times.
- Lifting capacities apply to only machine as originally manufactured and normally equipped by KOBELCO CONSTRUCTION MACHINERY CO., LTD.

SK350LC		Super Short Arm: 2.25 m Bucket: Without Shoe: 800 mm Counterweight: 7,890 kg										
B	A	3.0 m		4.5 m		6.0 m		7.5 m		At Max. Reach		Radius
												
7.5 m	kg					*8,450	*8,450			*8,400	*8,400	6.73 m
6.0 m	kg					*8,800	*8,800	*8,090	7,410	*8,080	7,040	7.71 m
4.5 m	kg					*9,720	*9,720	*8,350	7,200	*8,000	6,110	8.31 m
3.0 m	kg					*10,800	9,390	*8,830	6,910	*8,020	5,650	8.61 m
1.5 m	kg					*11,590	8,930	*9,230	6,650	*8,110	5,500	8.64 m
G.L.	kg					*11,810	8,710	*9,350	6,500	*8,210	5,650	8.40 m
-1.5 m	kg			*14,640	13,200	*11,370	8,690	*8,890	6,520	*8,260	6,160	7.87 m
-3.0 m	kg	*15,420	*15,420	*12,790	*12,790	*10,010	8,880			*8,110	7,360	6.98 m
-4.5 m	kg			*9,290	*9,290					*7,170	*7,170	5.56 m

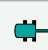
SK350LC		Short Arm: 2.60 m Bucket: Without Shoe: 800 mm Counterweight: 7,890 kg										
B	A	3.0 m		4.5 m		6.0 m		7.5 m		At Max. Reach		Radius
												
7.5 m	kg									*7,790	*7,790	7.06 m
6.0 m	kg					*8,330	*8,330	*7,630	7,430	*7,570	6,640	8.00 m
4.5 m	kg			*11,970	*11,970	*9,290	*9,290	*7,990	7,190	*7,530	5,790	8.58 m
3.0 m	kg					*10,420	9,420	*8,530	6,880	*7,590	5,350	8.87 m
1.5 m	kg					*11,320	8,910	*9,010	6,590	*7,710	5,200	8.89 m
G.L.	kg			*15,750	12,960	*11,680	8,630	*9,220	6,410	*7,870	5,320	8.66 m
-1.5 m	kg			*14,930	13,010	*11,410	8,570	*8,960	6,380	*8,000	5,760	8.15 m
-3.0 m	kg	*16,830	*16,830	*13,300	13,250	*10,320	8,710			*8,000	6,780	7.29 m
-4.5 m	kg	*12,690	*12,690	*10,270	*10,270					*7,500	*7,500	5.95 m

SK350LC		Standard Arm: 3.30 m Bucket: Without Shoe: 600 mm Counterweight: 7,890 kg														
A	B	1.5 m		3.0 m		4.5 m		6.0 m		7.5 m		9.0 m		At Max. Reach		
																Radius
9.0 m	kg													*5,750	*5,750	6.56 m
7.5 m	kg									*6,910	*6,910			*5,260	*5,260	7.86 m
6.0 m	kg									*7,010	*7,010			*5,080	*5,080	8.71 m
4.5 m	kg							*8,610	*8,610	*7,490	7,160	*6,910	5,310	*5,080	5,060	9.25 m
3.0 m	kg					*13,360	*13,360	*9,860	9,440	*8,140	6,820	*7,170	5,160	*5,250	4,700	9.52 m
1.5 m	kg					*15,280	13,170	*10,960	8,850	*8,750	6,490	*7,450	4,990	*5,580	4,570	9.54 m
G.L.	kg					*15,930	12,690	*11,600	8,470	*9,150	6,260	*7,570	4,880	*6,150	4,640	9.33 m
-1.5 m	kg			*13,950	*13,950	*15,590	12,590	*11,640	8,310	*9,150	6,150			*7,100	4,960	8.85 m
-3.0 m	kg	*15,880	*15,880	*19,570	*19,570	*14,400	12,720	*10,970	8,350	*8,490	6,200			*7,560	5,660	8.07 m
-4.5 m	kg			*15,910	*15,910	*12,080	*12,080	*9,170	8,610					*7,450	7,210	6.88 m

SK350LC		Standard Arm: 3.30 m Bucket: Without Shoe: 800 mm Counterweight: 7,890 kg														
A	B	1.5 m		3.0 m		4.5 m		6.0 m		7.5 m		9.0 m		At Max. Reach		
																Radius
9.0 m	kg													*5,750	*5,750	6.56 m
7.5 m	kg									*6,910	*6,910			*5,260	*5,260	7.86 m
6.0 m	kg									*7,010	*7,010			*5,080	*5,080	8.71 m
4.5 m	kg							*8,610	*8,610	*7,490	7,370	*6,910	5,480	*5,080	*5,080	9.25 m
3.0 m	kg					*13,360	*13,360	*9,860	9,720	*8,140	7,030	*7,170	5,330	*5,250	4,860	9.52 m
1.5 m	kg					*15,280	13,590	*10,960	9,130	*8,750	6,710	*7,450	5,160	*5,580	4,730	9.54 m
G.L.	kg					*15,930	13,110	*11,600	8,750	*9,150	6,470	*7,570	5,050	*6,150	4,810	9.33 m
-1.5 m	kg			*13,950	*13,950	*15,590	13,000	*11,640	8,590	*9,150	6,360			*7,100	5,130	8.85 m
-3.0 m	kg	*15,880	*15,880	*19,570	*19,570	*14,400	13,140	*10,970	8,630	*8,490	6,410			*7,560	5,860	8.07 m
-4.5 m	kg			*15,910	*15,910	*12,080	*12,080	*9,170	8,890					*7,450	7,440	6.88 m

STANDARD EQUIPMENT

ENGINE

- Engine, HINO J08EUN, diesel engine with turbocharger and intercooler
- Automatic engine deceleration
- Auto Idle Stop (AIS)
- Batteries (2 x 12V - 96Ah)
- Starting motor (24V - 5 kW), 60 amp alternator
- Automatic engine shut-down
- Engine oil pan drain cock
- Double element air cleaner

CONTROL

- Working mode selector (H-mode, S-mode and ECO-mode)
- Power Boost

SWING SYSTEM & TRAVEL SYSTEM

- Swing rebound prevention system
- Straight propel system
- Two-speed travel with automatic shift down
- Sealed & lubricated track links
- Grease-type track adjusters
- Automatic swing brake
- Tow eyes

HYDRAULIC

- Boom regeneration system
- Auto warm up system
- Aluminum hydraulic oil cooler
- Arm interflow system
- Hydraulic fluid filter clog detector

MIRRORS & LIGHTS

- Two rear view mirrors
- Five front working lights (Two for boom, one for boom cylinder, one for right storage box and one for cab)

CAB & CONTROL

- Two control levers, pilot-operated
- Horn, electric
- Cab light (interior)
- Luggage tray
- Large cup holder
- Detachable two-piece floor mat
- Headrest
- Handrails
- Intermittent windshield wiper with double-spray washer
- Skylight
- Tinted safety glass
- Pull-up type front window and removable lower front window
- Easy-to-read multi-display color monitor
- Automatic air conditioner
- Emergency escape hammer
- KOMEXS
- Suspension seat

OPTIONAL EQUIPMENT

- Additional track guide
- N & B piping
- Refilling pump
- Rear view camera
- Cab guard
- Two cab lights

Note: Standard and optional equipment may vary. Consult your KOBELCO dealer for specifics.

Note: This catalog may contain attachments and optional equipment that are not available in your area. And it may contain photographs of machines with specifications that differ from those of machines sold in your areas. Please consult your nearest KOBELCO distributor for those items you require. Due to our policy of continuous product improvements all designs and specifications are subject to change without advance notice. Copyright by **KOBELCO CONSTRUCTION MACHINERY CO., LTD.** No part of this catalog may be reproduced in any manner without notice.

PT. DAYA KOBELCO CONSTRUCTION MACHINERY INDONESIA

Head Office

Jl. Halmahera Blok DD-10 Kawasan Industri MM2100
 Desa Danau Indah, Cikarang Barat
 Kabupaten Bekasi, Jawa Barat 17530
 Telp : 021-22143080 Fax : 021-22143081

Sales & Marketing Office

Pondok Indah Office Tower 3, 8th Floor Suite 804
 Jl. Sultan Iskandar Muda, Pondok Indah Kav V-TA
 Jakarta Selatan 12310
 Telp : 021-29327911, 021-29327912

Inquiries To:

SK330/SK350LC-10-SEASIA-D(SRI)-102-170503EF